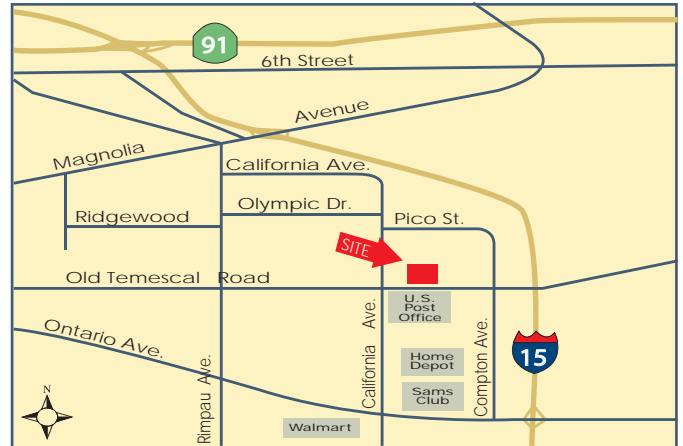

FOR LEASE**5,180 SF | Corona, CA | Freestanding Concrete Tilt-Up Office Building**Presented by Strata Realty, Inc. | www.coronaspectrum.com | T (951) 280-1733 | F (951) 280-1739**5,180 SF FREESTANDING OFFICE BUILDING****Location**1875 California Avenue
Corona, CA 92881**Features**

- Four (4) private offices
- Herculite Glass Conference Room
- Large Executive Office or Small Conference Room
- Large Open Bull Pen
- Private Men's and Women's Restrooms
- Break Room
- Large Reception Area with Natural Stone Flooring
- Kitchenette
- Copy Center
- Operable Windows
- Fountain Views
- 4:1 Parking Ratios
- Recently Approved for Medical
- Great signage and visibility on California Avenue

**Contact:****Timothy Hawke, SIOR**(951) 280-1733 | thawke@stratarealty.com**Jason Palda**(951) 280-1733 | jpalda@stratarealty.com**Adam Silverman**(951) 280-1733 | asilverman@stratarealty.com**DRE Information**Timothy Hawke's license number is 01403432
Jason Palda's license number is 01820370
Adam Silverman's license number is 01397929

FOR LEASE

5,180 SF | Corona, CA | Freestanding Concrete Tilt-Up Office Building

Contact: **Tim Hawke, Jason Palda, Adam Silverman** | www.coronaspectrum.com | T (951) 280-1733

FLOOR PLAN

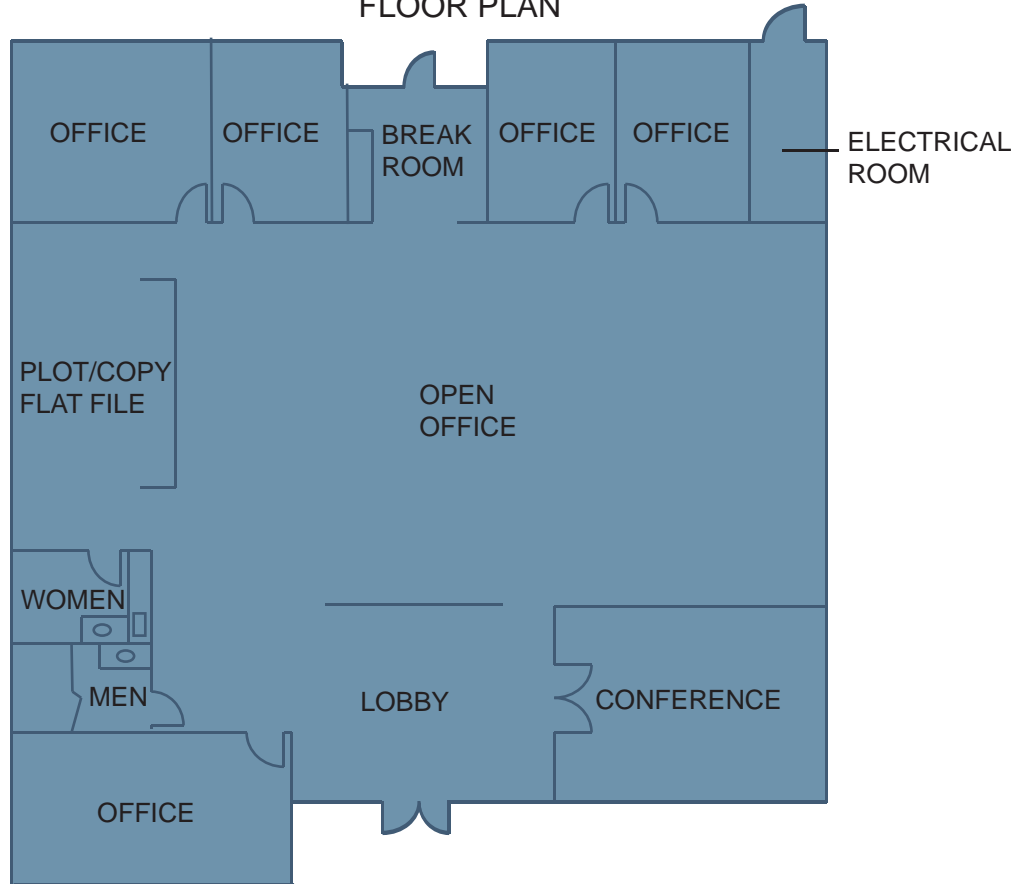

DRE Information